

PROJECT AURA

YN19650 | 50M STEEL



A luxury yacht is shown from a front-three-quarter perspective in a dark, industrial setting, possibly a shipyard or a museum. The yacht is illuminated by dramatic, focused spotlights, creating a high-contrast scene with deep shadows and bright highlights on the boat's surfaces. The background is dark with some faint, glowing lines, suggesting a large, open space. The overall mood is sophisticated and high-tech.

Holland, home of yacht building

It is no coincidence that many of the best shipyards in the world are found in Holland. Our passion for yacht building and commitment to quality is unrivalled. And that is what makes Heesen Yachts the world's leading builder of high-performance yachts. We hope to see you soon to realise your dream.



HEESEN

SERIES

All of our Heesen Series yachts have a proven track record, based upon the experience we have gained from previous builds. These yachts are fully designed and engineered. We can deliver them faster because we build them as speculative ventures. Customisations to the interior can still be made but are dependent on delivery times and schedule.

- Total proven yacht engineering and design
- Fast delivery due to our speculation programme
- Customisation options possible to a certain extent

HEESEN

SMART CUSTOM

Our Smart Custom yachts are fully engineered above and below the main deck but can be offered with a custom- designed superstructure. These yachts benefit from our proven track record in hull design and technology. All together, our Smart Custom yachts enjoy a smart balance between performance, speed of delivery and customisation.

- Proven hull engineering and design
- Faster delivery due to shorter engineering times
- Custom choice of superstructure and more elements

HEESEN

FULL CUSTOM

Our Full Custom offer starts with a blank sheet of paper or is inspired by one of our concepts. All the client's wishes are fully considered by our naval architects and designers. If requested by the client, we offer ideas and insight based on our previous full-custom yachts. To highlight our design and building capabilities, we also create concepts to inspire potential clients and stakeholders in the market.

- Start the design process from the beginning
- One unique yacht in the water
- Personalised value

Exterior design



Blending practicality with luxurious detail, this 164 ft (50m) steel-hulled motor yacht has been optimized to deliver the largest possible enclosed volume while remaining under the 500 GT threshold.

Wrapped in a refined yet striking exterior by Clifford Denn, Project Aura makes a splash for all the right reasons. Delivered in 2022, Project Aura spent the summer in the Mediterranean and crossed the Atlantic Ocean on her bottom. Privately owned by an experienced yachtsman, Project Aura debuts at the Fort Lauderdale International Boat Show.

Precision and performance

A true bluewater motor yacht ideal for cruising in comfort, Project Aura features a displacement hull designed by Heesen's in-house team of naval architects and engineers. Two MTU 8V4000 M63 engines provide a top speed of 15 knots. A drag-cheating bulbous bow allows her to glide through the water with ease. She boasts a transoceanic range of 3,800 nautical miles at a cruising speed of 13 knots.





Interior Design



Step aboard Project Aura and enter an interior world of Scandinavian chic. Here simplicity and function seamlessly blend. Natural materials come to the fore, mixing woods and leather with daring, geometrical printed fabrics. British studio Reymond Langton Design has fused inner tranquillity with exterior masculinity resulting in a light, airy and fresh environment.

Ten guests are accommodated in five large staterooms, with the owner's suite on the main deck forward. With tender and toys conveniently stored on the foredeck, the transom houses a generous beach club to enjoy life closer to the water and the action.



Specifications

Project Aura 50m Steel

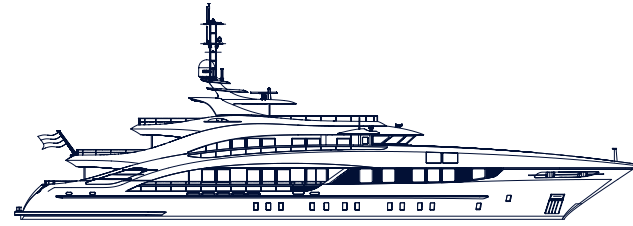

General

Yacht numer	19650
Hull type	Twin propeller motor yacht, displacement
Naval architect	Heesen Yachts
Exterior design	Clifford Denn Design
Interior design	Reymond Langton Design
Classification	Lloyd's ✕ 100A1 SSC YACHT [✕]LMC Large Commercial Yacht Code REG-YC
Hull	Steel
Superstructure	Aluminium

Dimensions

Length over all	49.9 metres / 163 feet 8 inches
Beam over all	9.00 metres / 29 feet 6 inches
Draft	2.75 metres / 9 feet
Displacement (half load)	Approximately 440 tons
Tonnage	Approximately 499 GT

Accommodations

Crew	9
Guests	10
Suites	Full-beam owner's stateroom, three double guest suites and one twin guest suite ull-beam owner's stateroom, 6 twin and 2 VIP suites

Technical Details

Maximum speed (half load)	15 knots
Range at 13 knots	3,800Nm
Fuel capacity	60,000 litres / 15,850 US Gallons
Fresh water	20,000 litres / 5,300 US Gallons

Propulsion Details

Main engines	2 x MTU 8V4000 M63
Maximum power	2 x 1,000kW
Gearbox:	2 x ZF model 5311
Engine control	MTU Blue Vision (New Generation)
Propellers	2 x five blade fixed pitch
Main generators	2 x Zenoro, 118kW, 50 Herz
Emergency generators	1 x Zenoro, 99kW
Bowthruster	Thruster Systems HRP 1001 90kW, hydraulically driven
Stabilisers	Naiad Dynamics, 2 fins, type 575, zero speed



General Arrangement

Sun deck

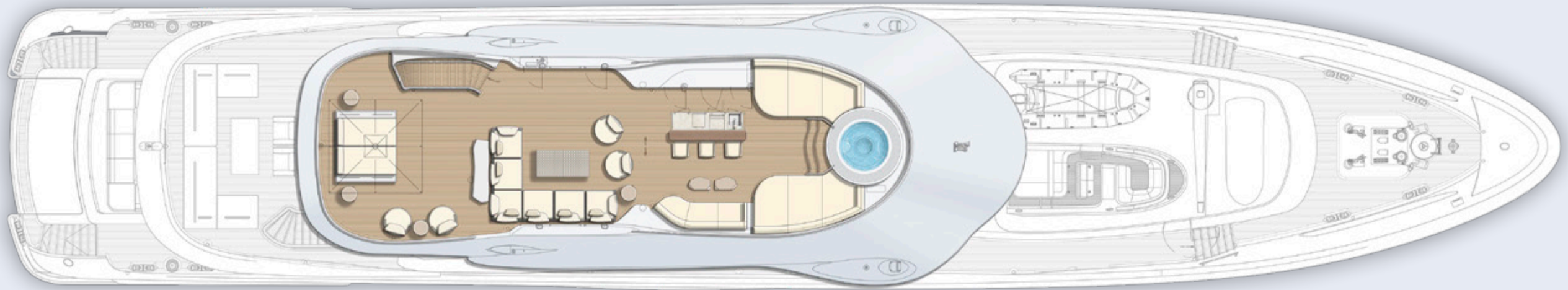

Wheelhouse deck

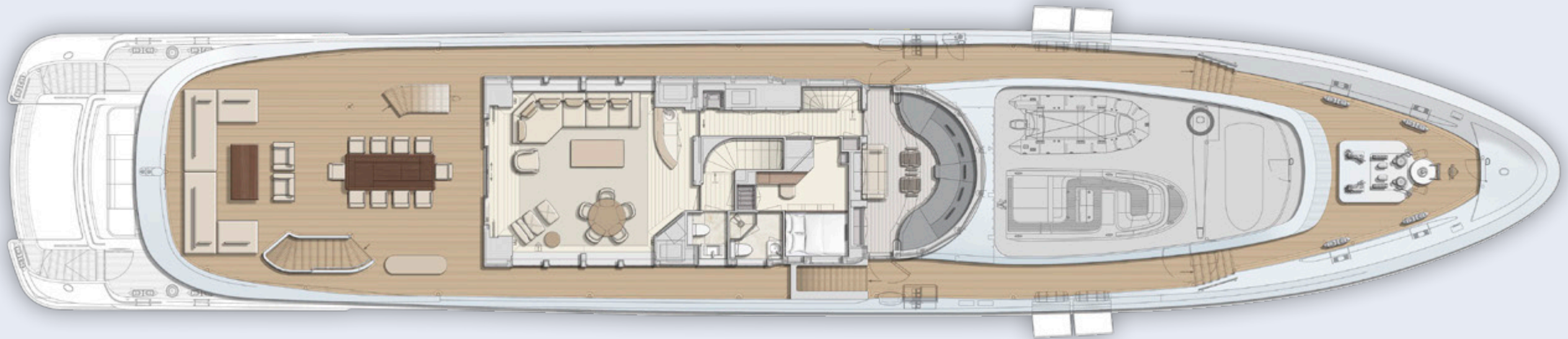

General Arrangement

Main deck



Lower deck



Shipyard

Ever since Frans Heesen started out in 1978, the shipyard has continuously expanded and improved its infrastructure and docks. Today, it is one of the most advanced and well-equipped yacht-building facilities in the world.

The shipyard is located in the Dutch city of Oss, 150 kilometres inland and connected to the North Sea by a series of canals and rivers. Its 22,000 square metres

of covered area and 2,900 square metres of workshop space offer everything you need to construct a product as complex as a Heesen yacht. Production capacity has gradually increased with the addition of new docks. In 2016, following the success of the 65-metre Galactica Star and 70-metre Galactica Super Nova, a 90-metre shed with 85-metre dry dock were completed. These new facilities allow the construction of yachts up to 83 metres entirely in-house.

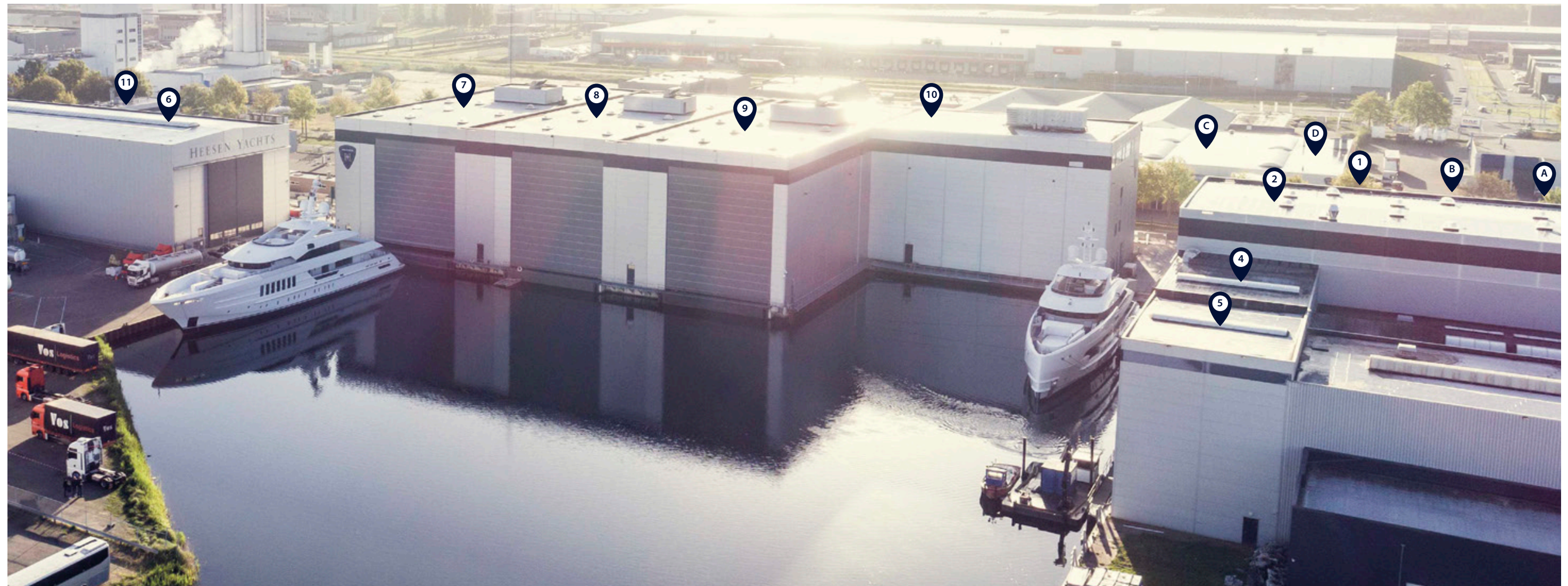

- 1. 50-metre slipway
- 2. 85-metre dry dock
- 4. 50-metre dry dock
- 5. 70-metre dry dock

- 6. Aluminium construction shed
- 7. 57-metre dry dock
- 8. 57-metre dry dock
- 9. 57-metre dry dock

- 10. Technical department / warehousing
- 11. Carpentry

- A. Offices
- B. Warehousing
- C. Crew offices
- D. Storage

Hightech craftsmanship

Building a yacht is one of the most challenging construction processes to be undertaken. Few processes require as many skills and expertise. What's more, in this high-tech era of robots and fully automated production, a Heesen yacht is still largely crafted by hand.

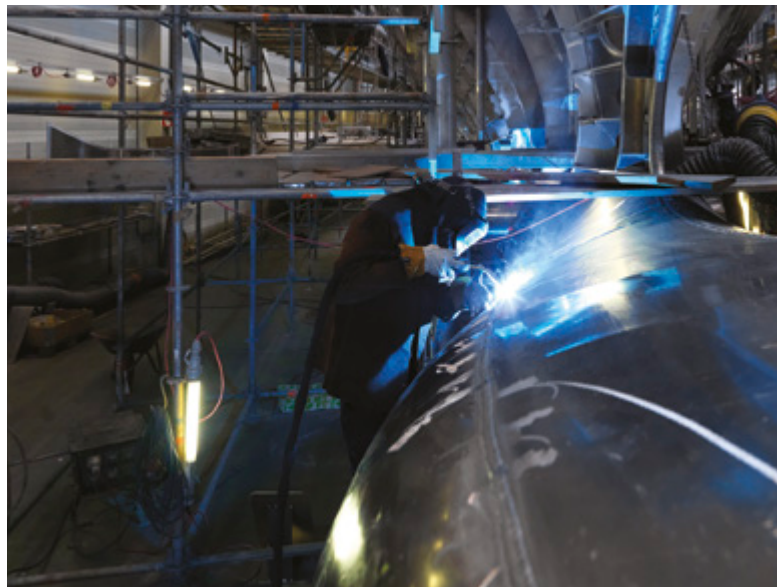

Heesen's modern shipyard in Oss builds yachts of up to 83 metres.

The design comes to life

The backbone of each Heesen yacht is expert welding to the highest tolerances. It is always a magical moment when the first contours of the hull appear, and the yacht's design comes to life. Heesen uses aluminium – which requires highly skilled and experienced welders – and steel to construct. The exterior outfitting stage is the largest unsung challenge of all builds; complex to the core, executed to perfection.



A perfect finish

Several layers of epoxy primer are applied to the aluminium and steel surfaces of the yacht, giving the hull and superstructure a smooth finish and a perfect basis for the paintwork. It takes a trained eye and skilful hands to apply each layer of coating and paint with exactly the right thickness. It's arduous work, too, which



is why Heesen equips its workers with industrial-grade exoskeletons. These fully mechanical passive suits provide protection against injury and fatigue. They alleviate the weight and physical stress of holding and working with tools in certain positions. And they also look pretty cool.

The marriage

The definitive shape of the yacht is determined by another key moment in the building process: the marriage, when the hull and superstructure are joined. It is all about perfect timing and precision when the crane operator lowers the superstructure onto the hull.



Hand-built imagination

As one of the few yacht builders to have an entire in-house department of interior specialists, Heesen guarantees consistent quality and custom design solutions that spark your imagination.

'Heesen builds its yacht interiors entirely in-house, a service that differentiates the shipyard from others in the world and enables it to guarantee the quality it promises'



Interior workshop

The shipyard's main interior workshop is situated in Winterswijk, just over an hour's drive from Oss, and provides more than 8,100 square metres of working space. Here, a large group of craftsmen work on up to five Heesen projects at the same time. This is where all of the luxury areas – such as the atrium, saloon, dining room, owner's stateroom and guest suites – are created. At the shipyard in Oss, another 30 craftsmen work on the interiors of all the service areas and sky lounges.

Rather unusually in this industry, Heesen builds its yacht interiors entirely in-house, which requires every type of machinery and skill on location. "This is something that has evolved over the years and we are very proud of it," Henry Schreur, director of Heesen Interiors, explains, "because we have been responsible for many award-winning yacht interiors." Schreur refers to the acclaimed My Sky, Galactica Star, Elena, Amore Mio and Galactica Super Nova.

This requires a lot of talent. It is one of many reasons why Heesen invests heavily in the acquisition of young talent.

Mock-up

The interior construction process consists of two phases. At first, the in-house interior department generates a four-square-metre mock-up of the proposed interior. This is a full-sized, fully finished interior fitted with handles, switches, lamps and even fabrics and flooring. If the owner agrees with the concept, the interior department then starts creating workshop drawings and sources all the materials, from the exotic to the everyday.

Exquisite materials

Once completed, the interior reaches the second phase – the actual creation process, which starts at both atelier locations. The craftsmen work with some exclusive wood types, including teak, wengé, Macassar ebony, walnut, flamed maple, as well as stained and curved glass, ray and goat skin, 3D printed elements, marble, onyx and other minerals. There are no limits to what the in-house interior specialists can create: the challenge lies in processing the materials in the right way.

Perfect finish

Naturally, raw materials such as bamboo, wood and leather differ from each other in their colour or texture. So to create uniformity, the interior specialists have to carefully treat each piece of wood by bleaching or staining, or colour the animal skin. As well as the material challenge of ensuring every piece looks exactly like its proposed design, weight, dimensions and time are other constraining factors for the craftsmen involved. However, even with last-minute changes, these professionals never take short cuts and always ensure that they install everything with a perfect finish.



Applying exclusive wood veneer



High level cabinet making



Painting with precision

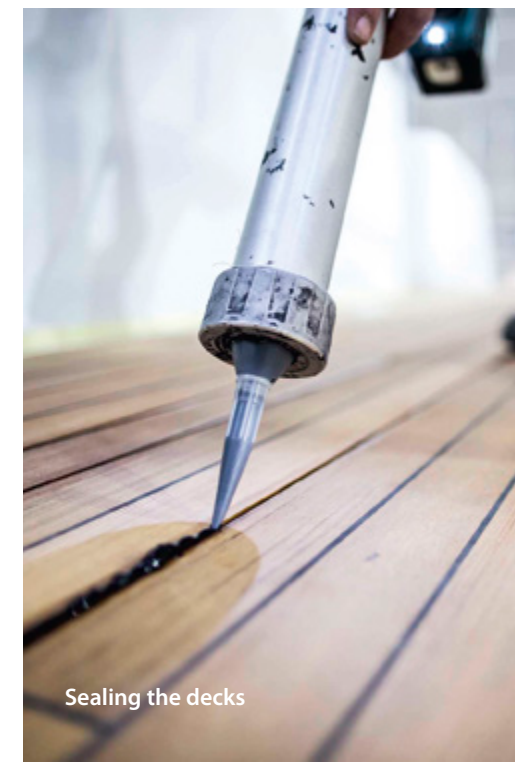

Sealing the decks

Interior assembly

All of the interior components are created in the wood shops in Oss and Winterswijk and are then assembled and finished on the yacht itself, which requires many different skills for a perfect result.

Contacts

HEADQUARTERS & SHIPYARD

Rijnstraat 2
5347 KL, Oss
The Netherlands
+31 412 66 55 44

AGENT NORTH AMERICA, MEXICO, BAHAMAS & CARIBBEAN

1819 SE 17th Street, Suite 2
Fort Lauderdale, Florida 33316
USA
+1 954 533 5040

AGENT MIDDLE EAST

Indigo Icon Tower – Office 508
Jumeirah Lakes Towers
P.O. Box 29717 – Dubai, UAE
+971 4 34 34 004

AGENT SOUTH EAST ASIA

204-B, Block “K”, Mukim 12,
Batu Maung, 11960, Penang,
Malaysia
+60 462 626 28

www.heesenyachts.com

© Heesen Yachts 2022. This brochure has been prepared for general marketing purposes. The information contained in this brochure (including without limitation any information concerning the dimensions, capabilities and performance characteristics of the subject yacht) is given in good faith but is not warranted to be accurate. All such information is subject to change at any time without notice. Heesen Yachts gives no warranty or representation, nor shall it be liable, in contract, tort or any other way, for any claims relating to or arising from any use made of any such information.



Crafted in Holland. Home of yacht building.